

Did you know that the total balance of the portfolio deposited with DCV amounts to

UF 8,706.4 MILLION?

This equals:
USD 294.2 BILLION



Decreased 5.1%
compared to the previous month.

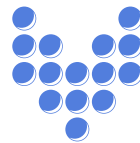

Decreased 6.9%
compared to March 2019.

Composition by instrument



98.4% electronic instruments and 1.6% printed instruments.

Composition of National Custody

Balance of the National Portfolio
UF 8,612.9 MILLIONS

This equals
USD 291 Billion



Decreased 5%
compared to the previous
month.

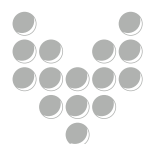

Decreased 6.8%
compared to March 2019.

UF 8,580.4 MILLION
in balance accounts.

UF 32.5 MILLION
in BRAA.

Composition by instrument

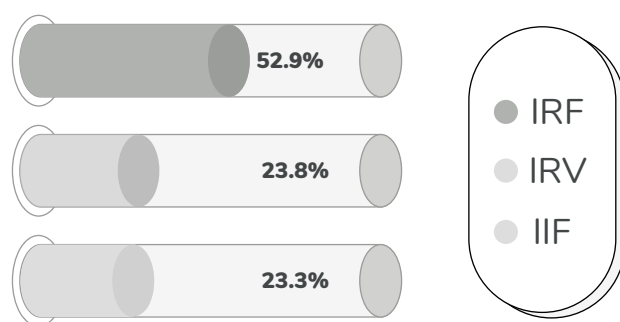

Composition in the National Portfolio

Time Deposits	21.1%
General Treasury Bond	17.5%
Bank Bond	17.3%
Shares	12.6%
Debentures	11.8%
Investment Fund Quotas	8.3%

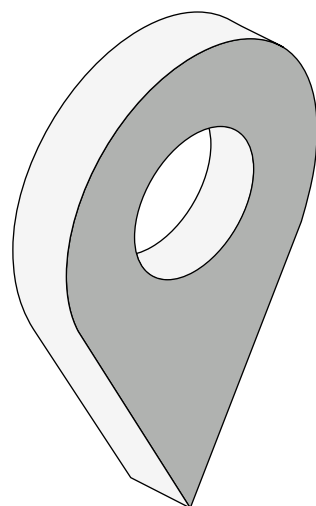

Subordinary Bonds	3.0%
Mutual Fund Quotas	2.9%
Discountable Promissory Notes of the CBCH	2.0%
CBCH Bonds	1.7%
Others	0.9%
Letters of Credit	0.5%
Recognition Bonds	0.4%

Composition of International Custody

Balance of the National Portfolio
UF 93.5 MILLIONS

This equals
USD 3,159 MILLIONS



Decreased 18%
compared to the previous month.



Decreased 20.5%
compared to March 2019.

UF 85.7 MILLIONS
in international custody
UF 7.8 MILLONES
In BVE

Composition by instrument

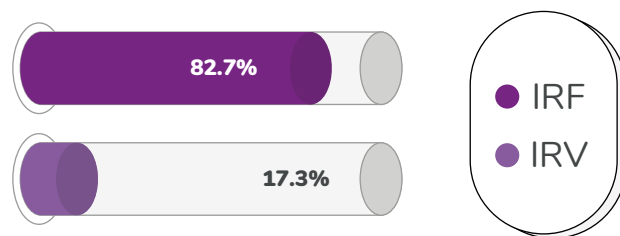

100% Electronic instruments

Composition in the International Portfolio



UF Transactions

registered in the DCV

Transaction Amount
UF 6,448.9 MILLIONS

This equals
USD 217.9 BILLION



Decreased 27.8%
compared to the previous
month.



Decreased 28.7%
compared to March 2019.

Number of Transactions per month **168,701**

Greater Volume of transaction in UF per instrument to:

December 2019

March 2020

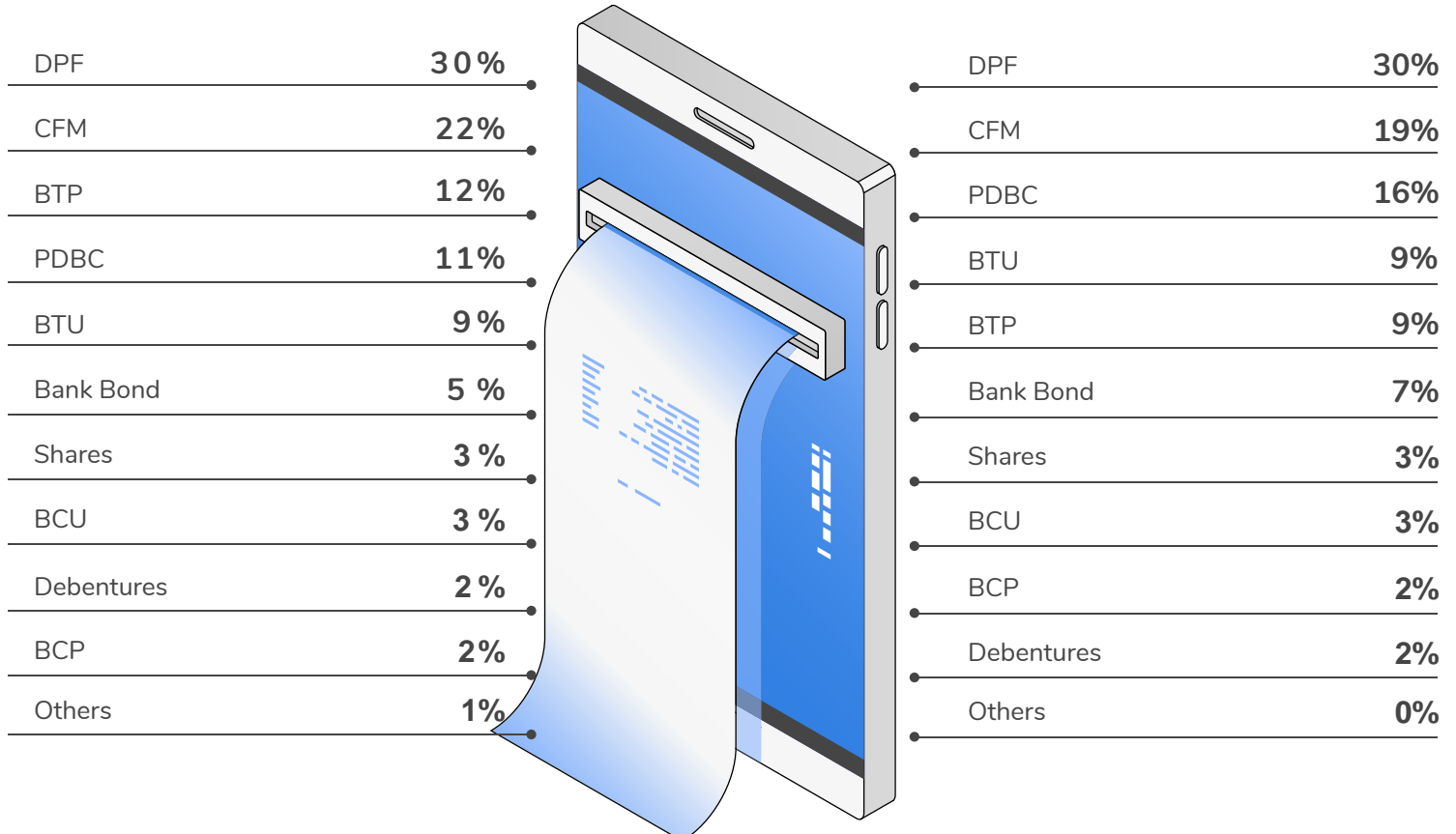

Greater Volume of transactions per instrument to:

December 2019

Shares	41%
DPF	36%
Bank Bond	6%
Debentures	4%
BTP	3%
BTU	2%
PDBC	2%
CFM	2%
CFI	2%
BCU	1%
Others	1%

March 2020

Shares	49%
DPF	31%
Bank Bond	5%
BTU	3%
PDBC	3%
BTP	3%
Debentures	2%
CFM	2%
CFI	1%
Others	1%
BCU	0%

